



Rotary Valves Type MVS



MVS 600 with direct drive

Applications

- Feeding and metering powders and granules
- Providing an airlock between a silo and a blowing line

Standard features

Fabricated steel body
Fabricated carbon steel rotor
Outrigged sealed for life bearings
Double lip type shaft seals
Electrically driven via a guarded chain drive from an IP55 gearmotor

Optional features

Range of body and rotor materials (ABRO, aluminum, stainless steel . . .)
Various rotor tip styles (friction relieved, polyurethane, adjustable high carbon . . .)
Stuffing box shaft seals
Mechanical, virtually maintenance free shaft seals
Air purged seals
Quick release rotor for frequent cleaning operations
Alternative drives
High temperature version
Custom sizes, square or rectangular

For aggressive applications we recommend the TWA extreme duty rotary valve

	Internal	External
Zone 0/20	✓	✗
Zone 1/21	✓	✓
Zone 2/22	✓	✓
APD	✓	✗

Midland Industrial Designers Limited

Common Lane, Watnall, Nottingham, England NG16 1HD
T: (+44)(0)115 9382154 F: (+44)(0)115 9386315
E: enquiry@mid.uk.com W: www.mid.uk.com
Manufacturers of powder handling equipment since 1959



Rotary Valves Type MVS

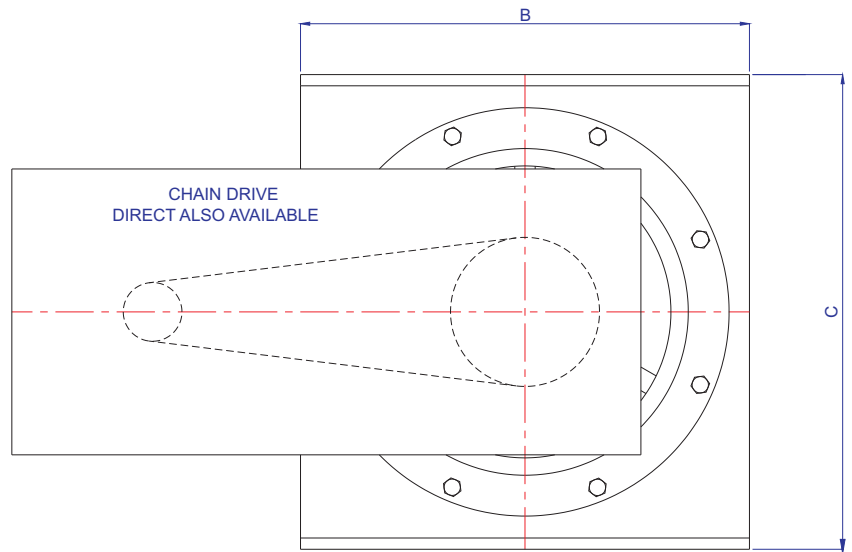
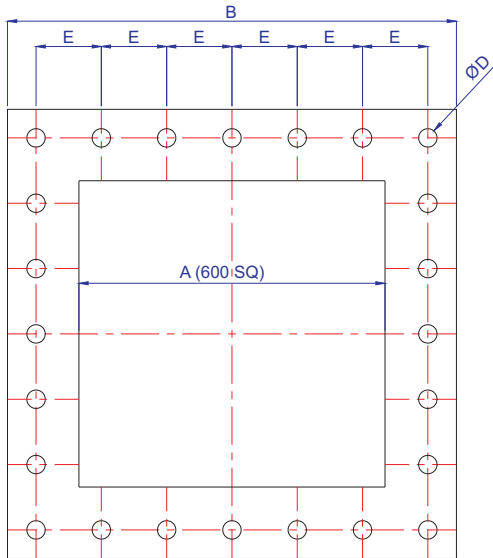
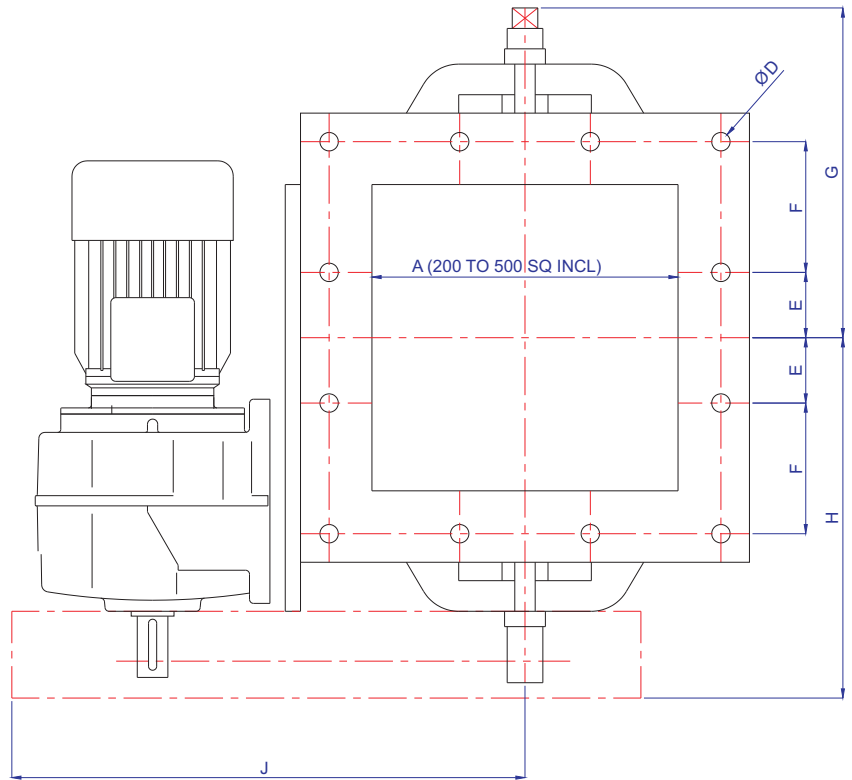
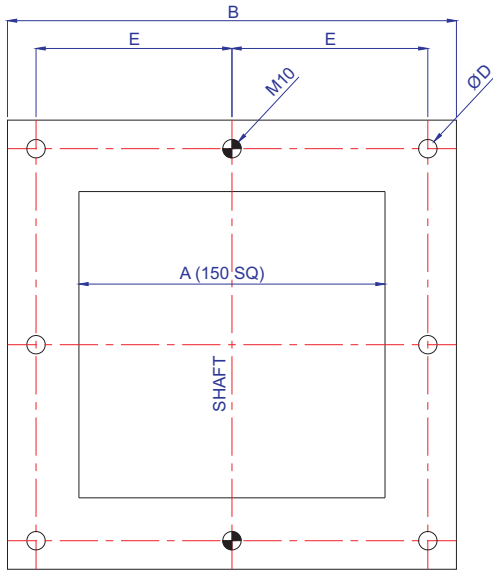

SIZE A	B SQ	C	D	E	F	G	H	J	l/rev	kW
150	280	250	12	115	-	213	233	354	2.5	0.12
200	300	310	12	45	90	260	280	400	6.2	0.37
250	370	388	18	54	108	275	292	450	12.2	0.55
300	440	465	18	64	128	323	353	503	20.6	0.75
350	490	520	14	75	145	348	382	536	32.5	1.1
400	550	580	18	85	170	385	425	585	49.5	1.5
450	600	640	18	90	180	378	419	620	61	1.5
500	650	670	18	100	200	447	515	635	92	2.2
600	800	770	18	148	-	633	654	685	140	3.0